

15 (0.6")

SERIES: 16, 28, 44, 57, 73

ACCEPTS: 13 GA aircraft cable with ball fitting

MATERIALS: white powder coated zinc.

MAXIMUM WEIGHT: 15kg (30lbs)

DESCRIPTION

This swag hook is designed for use with many series and allows for individual pendants to be precisely located anywhere in a space. It connects to the top of the pendant and directly above on the ceiling. Receives the cut end of a 13 gauge aircraft cable with ball fitting on the other end.

APPLICATION

For use with 16 series, copper suspended 28 series, 44 series, 57 series, and 73 series fixtures only. The length of the aircraft cable is adjustable on site with cable cutter, and is fastened using a set screw. Client is responsible for the provision of adequate substrate capable of suspending overall weight.

Vancouver
sales@bocci.ca
www.bocci.ca

Berlin
europa@bocci.ca
www.bocci.ca



Swag Hook

PRODUCT SPECIFICATION

1

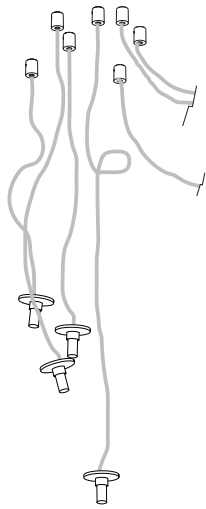

Install all copper lengths using the fixture specific installation instructions.

2

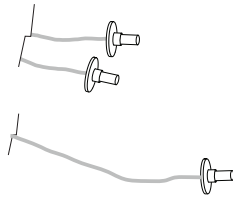

Determine which copper lengths to swag and begin bending them towards these points. Take care when bending the copper to keep from kinking it.

Using both hands close together, straighten a small section at a time.

Start on one end and work towards the other in a linear fashion.

Do not hold both ends at once to once to uncoil.

3

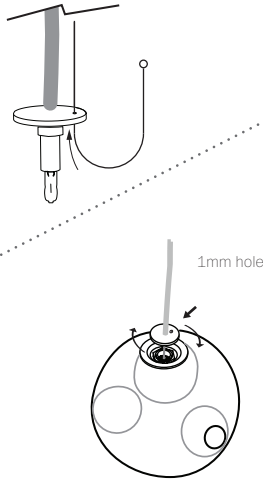

Take the aircraft cable and thread it through the copper cap with the ball-end of aircraft on the lamp side of the cap.

Install 28 pendant by inserting the socket into the opening and then threading the copper cap into the pendant by hand. Do not over tighten. Tighten set screw in cap with included 1.5mm allen key.

Note: once the pendant is added, it will pull the copper downwards. The pendant will try to hang directly below the canopy as the copper is not rigid enough for long horizontal compositions.

4

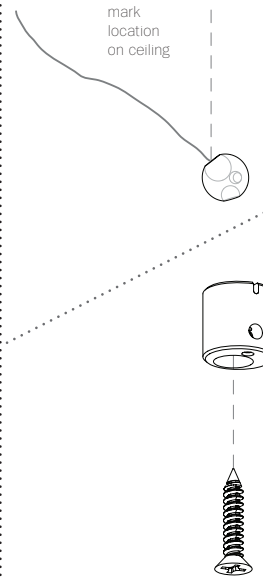

Mark a point directly above the pendants desired location and screw the swag hook into the ceiling using the fasteners provided.

Ensure that the ceiling is sufficiently strong enough to hold 2kg (5lbs).

5

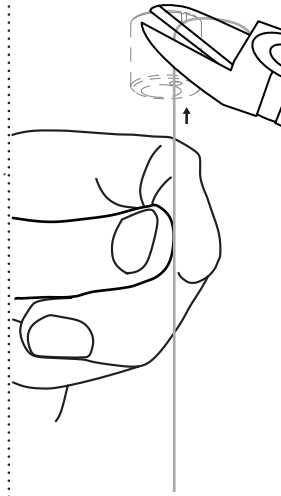

Raise the pendant and aircraft cable to the ceiling until the pendant is in the location desired and cut the aircraft cable using aircraft cutters.

6



Insert the aircraft cable into the small hole in the swag hook and tighten the set screw. Tie a knot in the cable to ensure that the cable does not slip through.

7

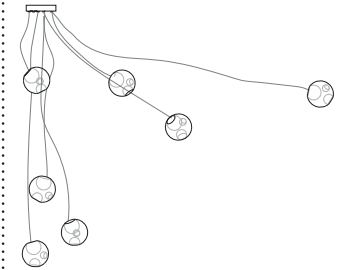

Clean fingerprints from glass surfaces.

Turn fixture on.

* Purchase replacement lamps or aircraft lengths online at bocci.ca/parts-store/

For additional assistance, please contact Bocci:

Vancouver
sales@bocci.ca
www.bocci.ca

Berlin
europe@bocci.ca
www.bocci.ca For additional information,
Worldwide patents issued and pending.

Made in Vancouver, Canada

www.bocci.ca

Berlin
europe@bocci.ca
www.bocci.ca



BOCCI

Copper Swag

INSTALLATION INSTRUCTIONS

© 2016, Bocci Design and Manufacturing Inc. Any inquiries should be directed to the following email address: info@bocci.ca