

adjustable  
up to 3000  
(10')  
standard

adjustable  
up to 24600  
(80')  
custom

approx 3.5kg (7.7lb)

- PENDANTS: three
- MOUNTING: brushed nickel canopy 152mm (6") in diameter x 32mm (1.3") deep
- LAMPING: 1.5w LED or 20w xenon
- CABLE: adjustable. 3000mm (10') standard / up to 24600mm (80') maximum
- MATERIALS: blown glass, braided metal coaxial cable, electrical components, swag hooks, aircraft cable, white powder coated canopy
- WEIGHT: approximately 3.5kg (7.7lb)
- POWER SUPPLIES: integral. Power supplies included

#### DESCRIPTION

28.3 is a cluster configuration of three 28 pendants hung from a round canopy. This fixture is designed to be horizontal, meaning that the pendants don't hang directly below, but instead trail off across a space, around a corner or simply deviate from their gravitational directive. As such, this fixture is designed to be hung from any number of optional swag points mounted elsewhere from the canopy.

Standard 28s are made with clear glass exterior spheres and milk white interior lamp holder cavities. 28s are possible with infinite versatility in colour compositions, sizes and shapes.

#### NOTES

- + Purchase replacement lamps online at [www.bocci.ca/lamps](http://www.bocci.ca/lamps)
- + Unless otherwise noted when ordering, all fixtures will be outfitted to be xenon compatible
- + As an alternative to integral power supplies, Bocci recommends mounting power supplies remotely in an easily accessible and hidden location for ease of long-term maintenance.
- + Aircraft cable lengths are adjustable on site - 3000mm (10') is the standard maximum. Drop lengths specified in 3m/10' increments and are cut to length on site with steel cable cutters (cutters not supplied).

US Patent # D687,740  
EU Patent # 001695834-001 to 004

Made in Vancouver, Canada

Vancouver  
sales@bocci.ca  
www.bocci.ca

Berlin  
europe@bocci.ca  
www.bocci.ca



CLUSTER  
**28.3** Design by Omer Arbel  
PRODUCT SPECIFICATION

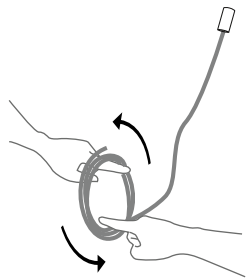

1

Very carefully uncoil the braided coaxial cable in a spool like manner. Insert your index fingers into opposite sides of the roll then rotate your fingers around each other to unroll the coaxial cable.

Use patience: allow the cable to uncoil completely to avoid kinks.

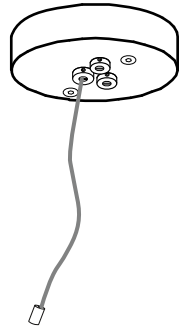

2

Determine the overall drop for the pendant fixture.

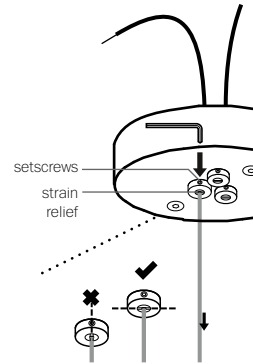

3

Thread the coaxial cables through the canopy, use a 2mm Allen key to loosen the setscrew in the canopy and gently feed the cable through until you have reached your desired drop length.

Use Allen key to tighten the setscrew to hold the strain relief and secure the coaxial cable at its new length. Perform a gentle tug test to ensure it is secure.

**DO NOT OVERTIGHTEN.**

Note: The strain relief is a black plastic collar around the coaxial cable. There is a single slot opening on the side of the strain relief component. It is essential that this opening is oriented at 90 degrees to set screw chamber. There can be no contact between the set screw and the cable.

**RISK OF ELECTRIC SHORT!**

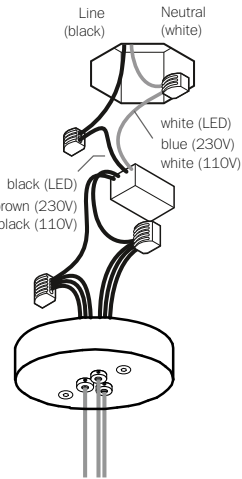

4

Xenon (110V) or LED: connect the black wire to black and white wire to white wire.

Xenon (230V): connect black wire to brown wire and white wire to blue wire.

Connect the coaxial cable to the open slots in the terminal block on the 12V side of the power supplies.

Ensure that the braided outer wires are all connected to one 12V output wire and all inner insulated wires are connected to the other or a short will occur.

Once all coaxial connections are made, lift the fixture into position and connect the line voltage to the open slot in the appropriate terminal block.

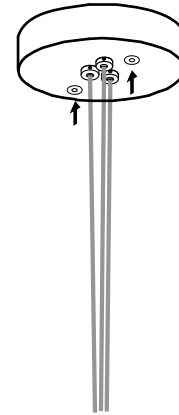

5

The client is responsible to ensure fasteners are attached to a robust structural substrate.

Tuck the power supply and wiring into the canopy. Line up the fastener holes or connect directly to structural ceiling surface using the fasteners provided.

Turn power to fixture on.



6

Bocci lamps are included. Plug the lamp into the socket. Do not touch the lamp with your bare hands. Check that each lamp is working properly as you go along.

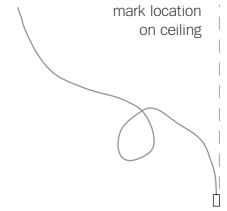

7

Mark a point directly above the pendants desired location and screw.

CLUSTER

28.3

Design by Omer Arbel  
PRODUCT INSTALLATION INSTRUCTIONS

© 2019, Bocci Design and Manufacturing Inc. All rights reserved. Any inquiries should be directed to: info@bocci.ca

**BOCCI**

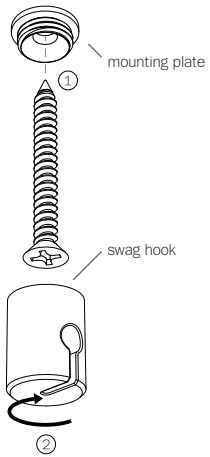

8

Ensure that the ceiling at the swag location is strong enough to hold 2kg (5lbs) before attaching swag hook with the provided screws.

Set the screws (provided) into an appropriate anchor (not provided).

Thread the swag hook on to the mounting plate, ensuring all the threads are engaged.

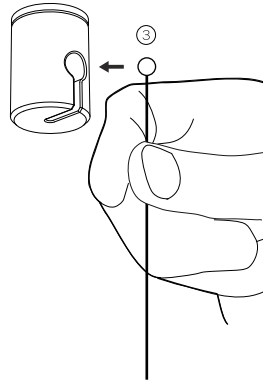

9

Slide the ball end of the aircraft into the slot on the swag hook. Give this a pull test, make sure that the ball is seated.

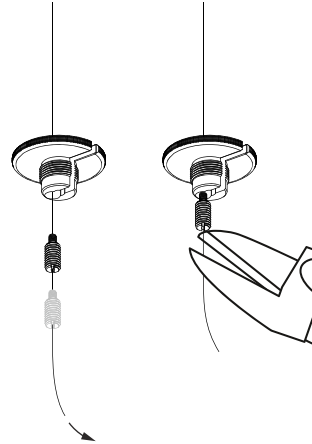

10

Feed the aircraft cable into the cable gripper. Slide the cable gripper into channel housing of center cap. Pull the aircraft cable and slide the cable gripper to adjust the height.

Cut the aircraft cable using aircraft cutters.

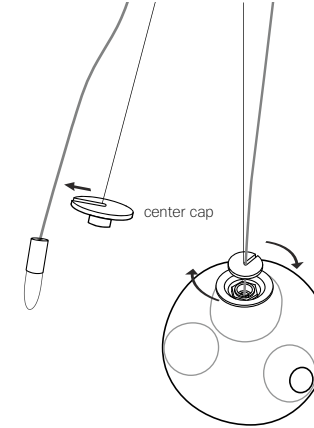

11

Slide the center cap onto the coaxial cable, gently insert the lamp into the pedant, then tighten the center cap connection by hand.

DO NOT OVERTIGHTEN.

Remove the protective film from the center cap after assembly.

Note: when using a dimmer use only low voltage electronic dimmer.

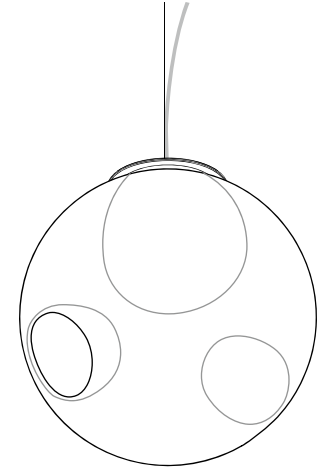

12

Clean fingerprints from surfaces.

For additional assistance, please contact Bocci:

Vancouver  
sales@bocci.ca  
www.bocci.ca

Berlin  
europe@bocci.ca  
www.bocci.ca

US Patent # D687,740  
EU Patent # 001695834-001 to 004

Made in Vancouver, Canada



LOW VOLTAGE LUMINAIRE  
E476186

SWAG

28.3

Design by Omer Arbel  
PRODUCT INSTALLATION INSTRUCTIONS

© 2019, Bocci Design and Manufacturing Inc. All rights reserved. Any inquiries should be directed to: info@bocci.ca

**BOCCI**